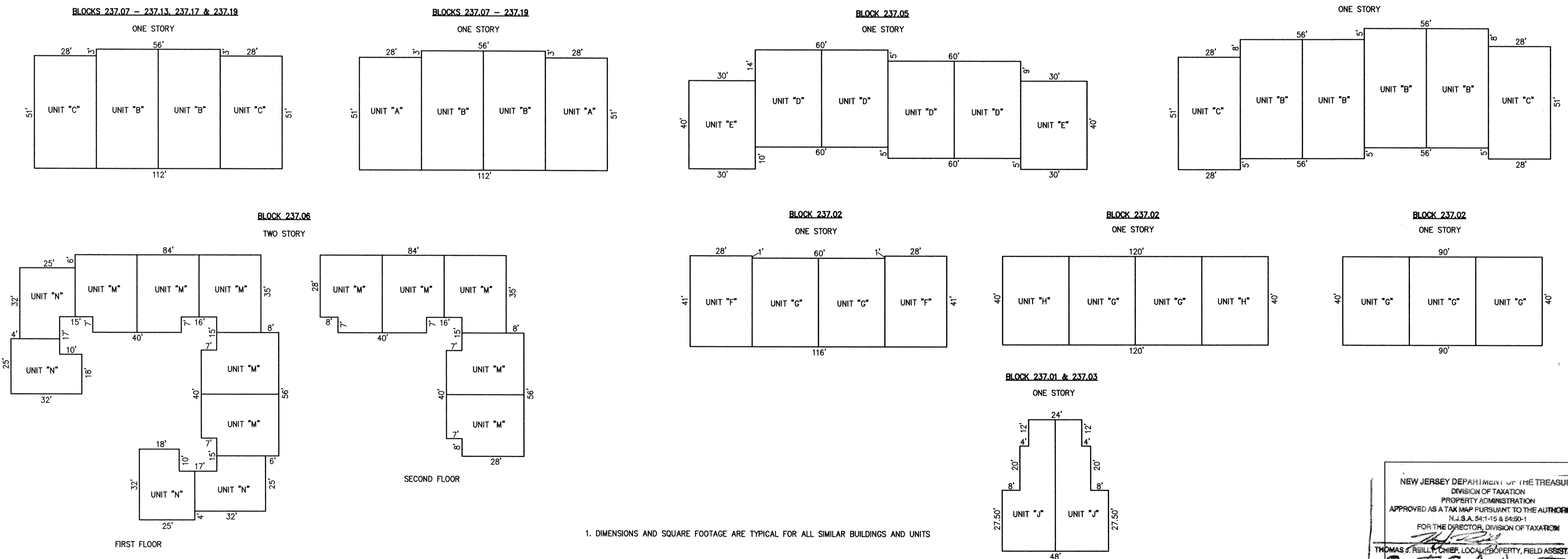
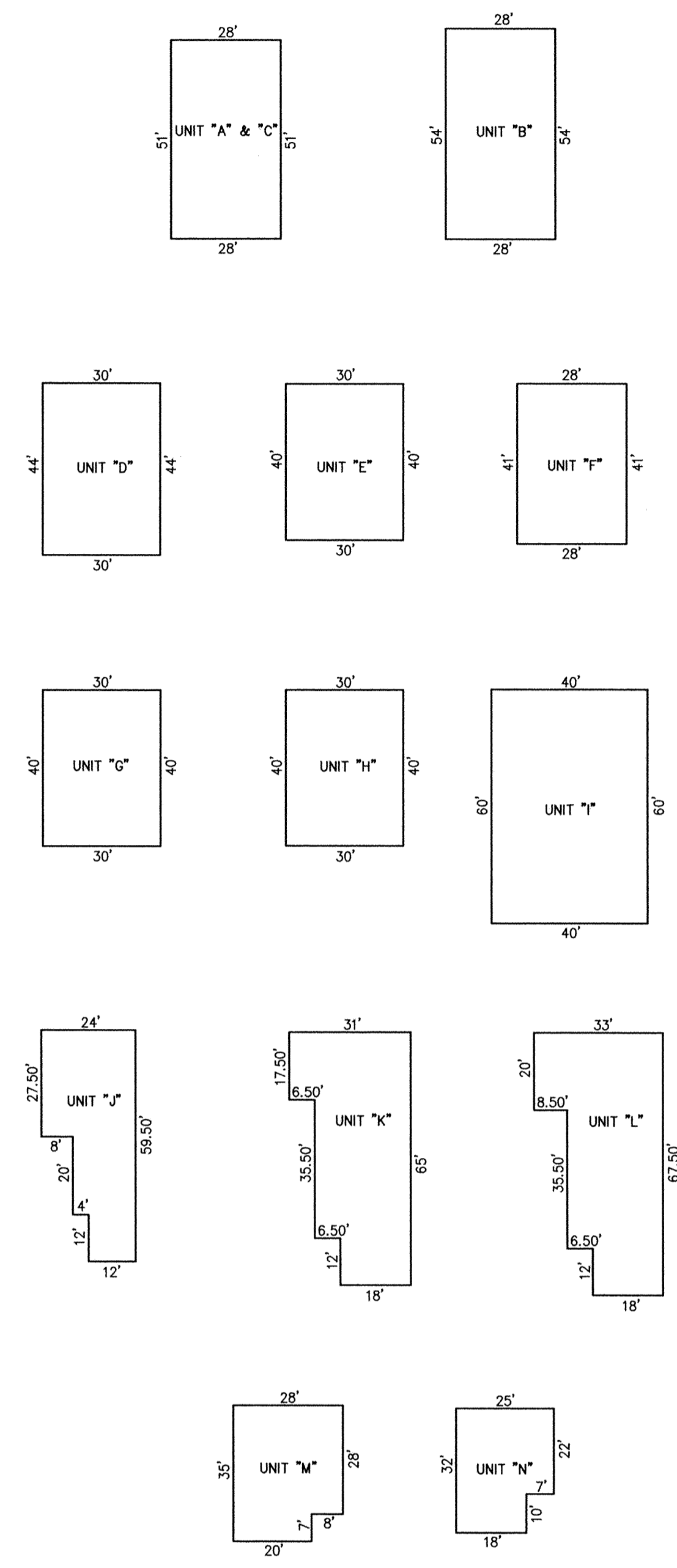

Table with columns for BLOCK NUMBER, LOT, UNIT, and UNIT SQ. FOOTAGE. Rows include units C-1001.01 through C-1016.02.

Table with columns for BLOCK NUMBER, LOT, UNIT, and UNIT SQ. FOOTAGE. Rows include units C-1001 through C-1018.



1. DIMENSIONS AND SQUARE FOOTAGE ARE TYPICAL FOR ALL SIMILAR BUILDINGS AND UNITS

DETAILS SCALE: 1"=30'

NEW JERSEY DEPARTMENT OF THE TREASURY DIVISION OF TAXATION PROPERTY ADMINISTRATION APPROVED AS A TAX MAP PURSUANT TO THE AUTHORITY OF N.J.S.A. REV. 17:27 & 17:28 FOR THE DIRECTOR, DIVISION OF TAXATION

DETAILS SCALE: 1"=30' BLOCKS 237.01 - 237.03, 237.05 - 237.20 THE WINDMILL CLUB EAGLE DRIVE TAX MAP TOWNSHIP OF HOWELL MONMOUTH COUNTY NEW JERSEY SCALE: AS NOTED DATE: 6-21-2005 CRAIG F. REMINGTON LAND SURVEYOR LIC. NO. 23924 REMINGTON, VERNICK & VENA ENGINEERS 24 GA 28003300 9 ALLEN STREET, TOMS RIVER, NJ 08753 (732) 286-9220, FAX (732) 505-8416 WEB SITE ADDRESS: WWW.RVVE.COM

THE WINDMILL CLUB PART OF OLD PLATE 18.01