

TOWNSHIP OF FREEHOLD
COUNTY OF MONMOUTH

141.04
21.01

SHEET 7.32

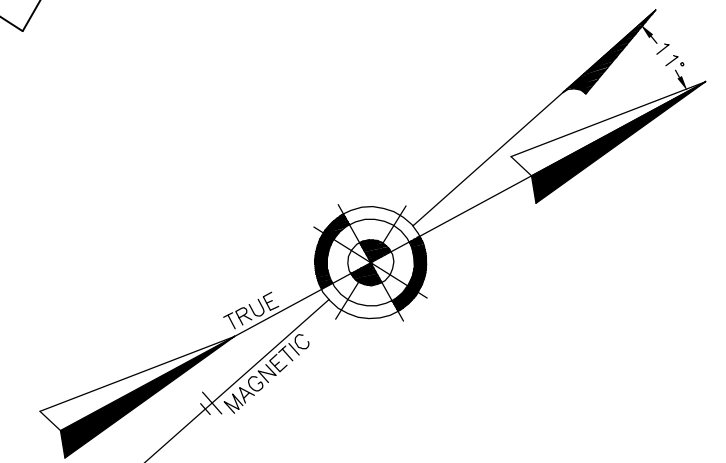

SHEET 7.29

INSET DETAIL "A"
SCALE: 1"=100'

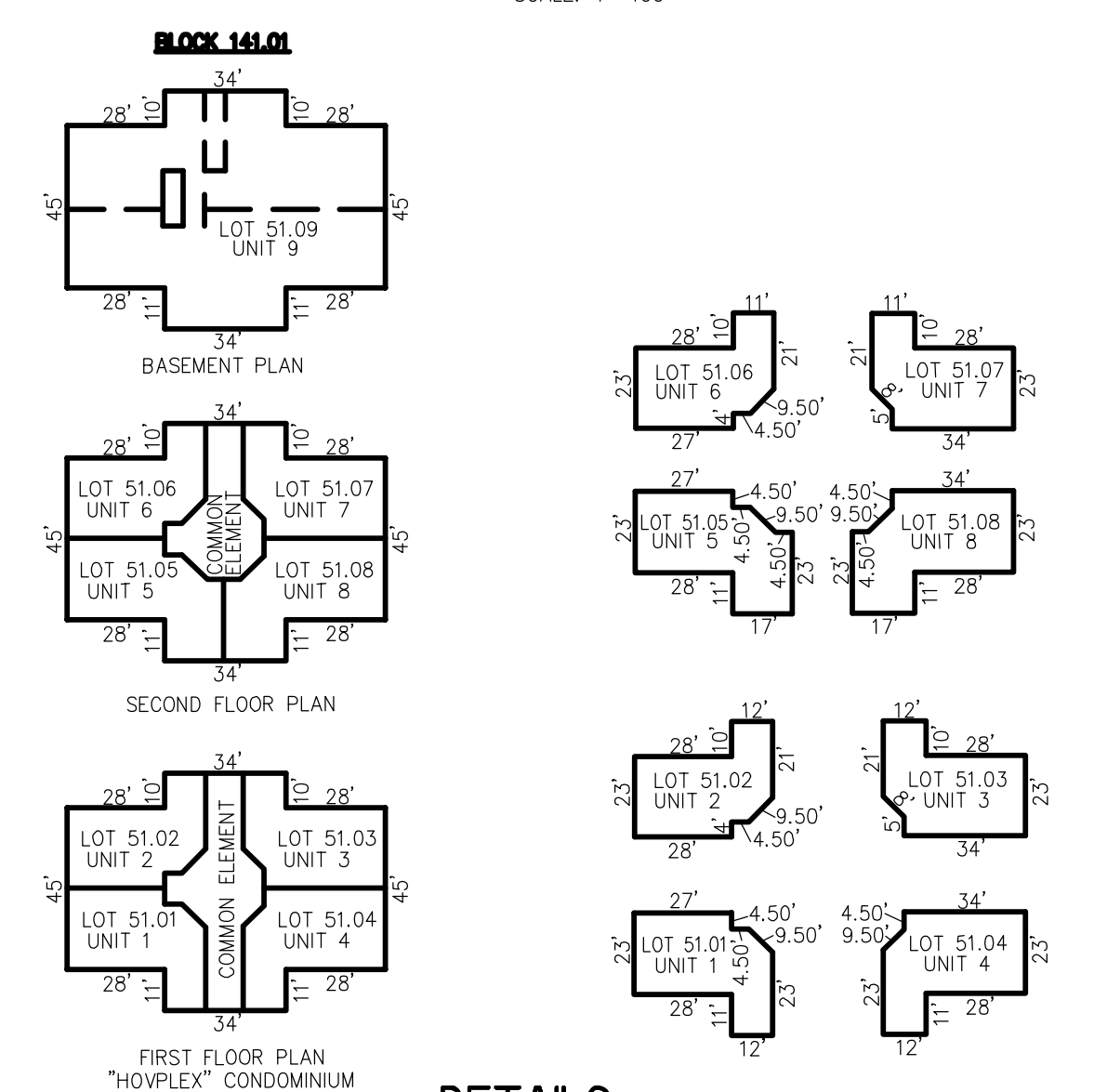

DETAILS
SCALE: 1"=50'

TAX MAP
TOWNSHIP OF HOWELL

MONMOUTH COUNTY NEW JERSEY
SCALE: 1" = 100' DATE: 6-21-2005

CRAIG F. REMINGTON LAND SURVEYOR LIC. NO. 23924

REMINGTON, VERNICK & VENA ENGINEERS
24 GA 28003300
9 ALLEN STREET, TOMS RIVER, NJ 08753
(732) 286-9220, FAX (732) 505-8416
WEB SITE ADDRESS: WWW.RVVE.COM

THIS SHEET WAS FORMALLY CERTIFIED ON
SEPTEMBER 15, 2009,
ASSIGNED SERIAL NUMBER 941,
SIGNED BY THOMAS J. REILLY, C.T.A.,
LOCAL PROPERTY, FIELD ASSISTANT
AND SANTO C. DIDONATO, C.T.A.,
SUPERVISING FIELD REPRESENTATIVE.

REVISIONS		
DATE	NAME	LIC. No.
05/25/11	RICHARD A. SCHULZ, P.L.S.	37607
07/20/12	RICHARD A. SCHULZ, P.L.S.	37607

LONG BROOK MANOR
PLATE 51.02 & PART OF OLD PLATES 43, 51, & 51.02