

# KEY MAP 5

NOTE:  
THIS SHEET HAS BEEN DRAWN USING COMPUTER AIDED DRAFTING/DESIGN (CAD/D) AND COORDINATE GEOMETRY (GOGO).

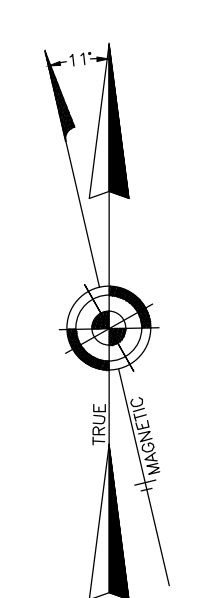
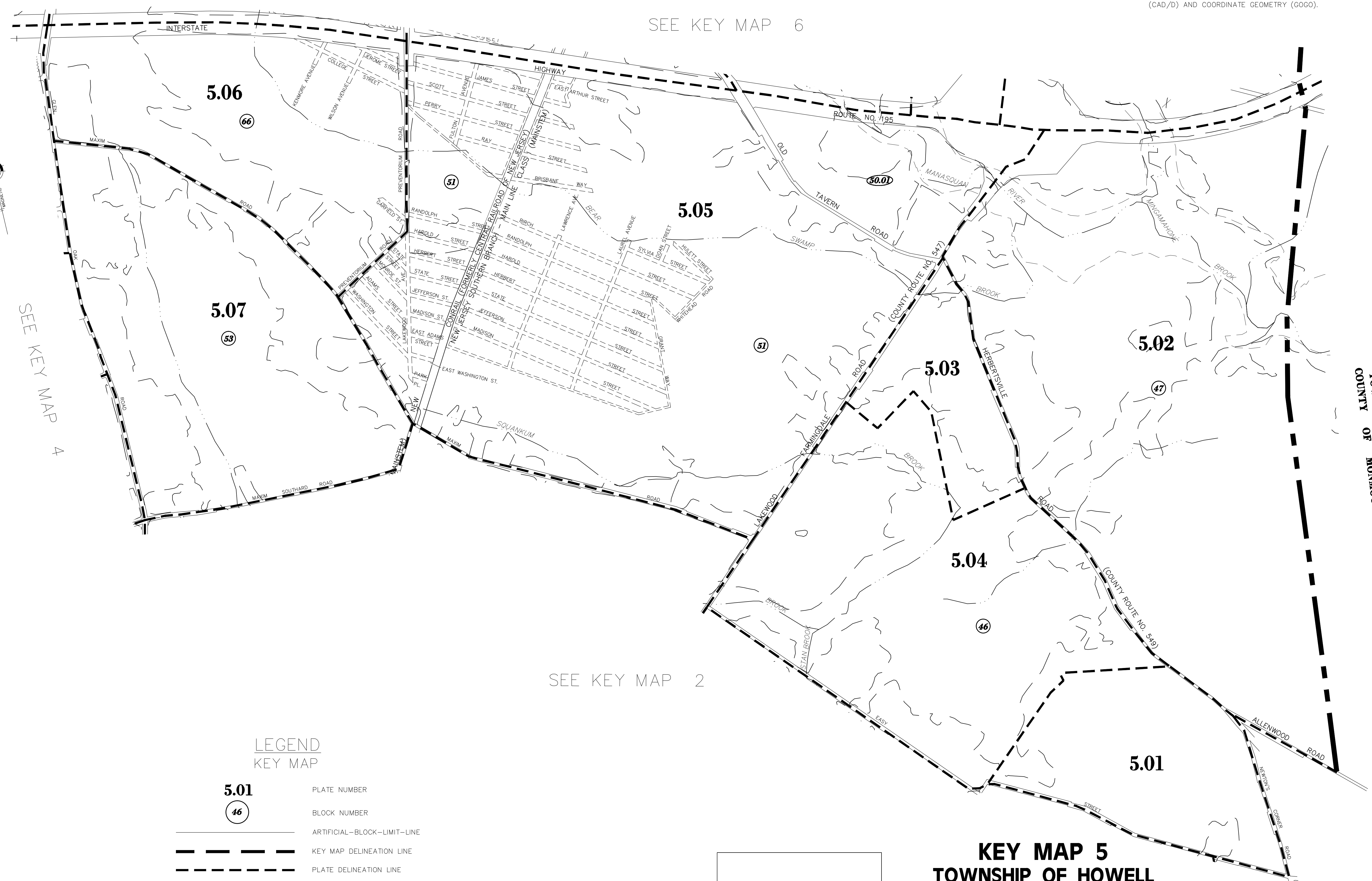

SEE KEY MAP 4

SEE KEY MAP 6

SEE KEY MAP 2

TOWNSHIP OF WALL  
COUNTY OF MONMOUTH

### LEGEND KEY MAP

- 5.01** PLATE NUMBER
- 46** BLOCK NUMBER
- ARTIFICIAL-BLOCK-LIMIT-LINE
- KEY MAP DELINEATION LINE
- PLATE DELINEATION LINE
- MUNICIPAL BOUNDARY LINE
- COUNTY BOUNDARY LINE
- WATERWAY LINES
- WETLAND AREA - W.L.A.
- FLOOD HAZARD AREA - F.H.A.

REVISIONS		
DATE	NAME	LIC. No.
08/17/12	RICHARD A. SCHULZ, P.L.S.	37607
02/15/16	GLEN J. LLOYD, P.L.S.	37598

THIS SHEET WAS FORMALLY CERTIFIED ON SEPTEMBER 14, 2009, ASSIGNED SERIAL NUMBER 941, SIGNED BY THOMAS J. REILLY, C.T.A., LOCAL PROPERTY, FIELD ASSISTANT AND SANTO C. DIDONATO, C.T.A., SUPERVISING FIELD REPRESENTATIVE.

## KEY MAP 5 TOWNSHIP OF HOWELL

MONMOUTH COUNTY NEW JERSEY  
SCALE: 1" = 600' DATE: 6-1-2005

CRAIG F. REMINGTON LAND SURVEYOR LIC. NO. 23924

REMINGTON, VERNICK & VENA ENGINEERS  
24 GA 28003300  
9 ALLEN STREET, TOMS RIVER, N.J. 08753  
(732) 286-9220, FAX (732) 505-8416  
WEB SITE ADDRESS: WWW.RVE.COM

# KEY MAP 5